

# InstruPack

## InstruPack's "ModRack" Junction Box Modular Rack

### InstruPack's "ModRack" Junction Box Modular Rack

InstruPack's 'ModRack' presents a prefabricated Junction Box Modular Rack, ready for installation without the need for on-site fabrication or hot work. This solution streamlines engineering, design, and installation processes, reduces safety risks, and potentially cuts installation time and costs.

InstruPack's cutting-edge solution, "ModRack," designed around the innovative "All in One Box" concept. This comprehensive package includes:

<b>Modular Support Rack Components:</b>	Vertical channel/beam supports, horizontal Unistrut supports, frames, brackets, and additional structural supports.
<b>Junction Boxes</b>	: Tailored to exact end-user specifications from approved vendors
<b>Mounting Hardware</b>	: Bolts, nuts, washers, and anchor fasteners for secure junction box installation
<b>Cable Management Accessories</b>	: Featuring cable trays and supports seamlessly integrated within the rack.
<b>Typical 3D Model Files</b>	: Facilitating effortless integration with plant models and streamlined bill of material extraction
<b>Optional Accessories</b>	: Sunshades, earthing cords, grating clamps, and more to enhance functionality as needed

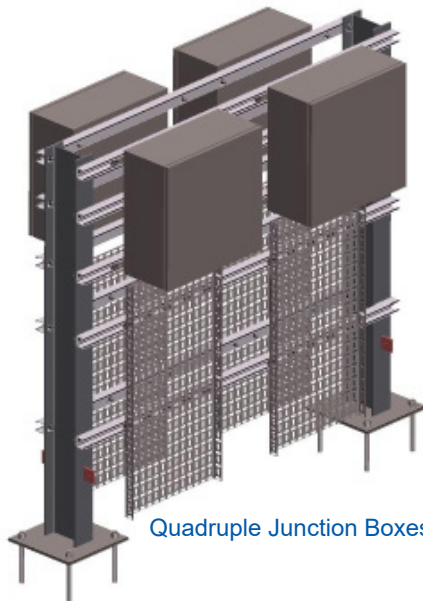

Quadruple Junction Boxes Rack

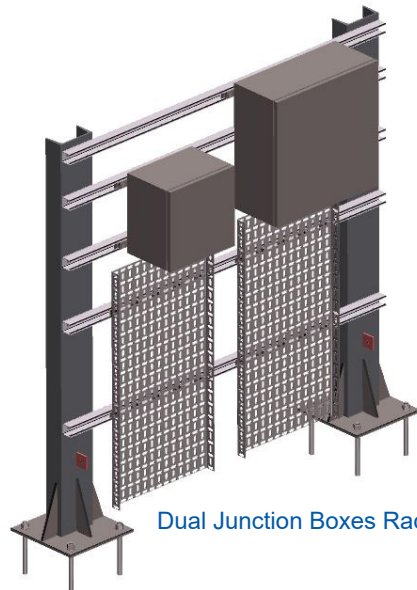

Dual Junction Boxes Rack

#### InstruPack offers typical standard configurations for junction box racks

- Single Junction Box Rack
- Dual Junction Boxes Rack
- Triple Junction Boxes Rack
- Quadruple Junction Boxes Rack
- Customization or expansion beyond above standard configurations to meet specific project needs available upon request.

#### Materials and Finishes for Supports and Accessories

- Hot-dipped Galvanized
- 304SS
- 316SS
- Painted
- Powder Coated

#### Typical Application:

- Field Junction Boxes Installation
- Outdoor Electrical Panels
- Motor Local Control Stations
- Remote I/O Panels
- Analyzers Cabinets

#### Cost-Effectiveness

- Reduce engineering and design time.
- Cataloged components eliminate design details.
- Minimize Material Wastage & Minimize workers for Installation.
- Effectively reduce the ideal man-hours at the construction site
- Reduce Skilled workers requirement at remote construction site

### Contact us



InstruPack LLC

Sharjah Media City

Sharjah, United Arab Emirates

Contact No: +971 528633274

Email: [sales@instrupack.com](mailto:sales@instrupack.com)

### Benefits of InstruPack's Junction Box Modular Rack

InstruPack's "ModRack" offers several advantages throughout the entire project life-cycle, from the initial design phase to the construction phase of industrial projects. It offers advantages such as simplified installation, reduced labour and cost and enhanced durability, making it an ideal solution for various industrial environments requiring efficient and reliable Instrumentation and electrical equipment installation. The "All in One Box" concept offers several significant advantages over traditional design and installation methods for junction box racks



#### Simplified Design/ Reduce Engineering Time

- InstruPack simplify the design process for engineers and designers. They can select and configure modules from the "ModRack" system to suit specific project requirements without the need for extensive custom design work.



#### Streamlined Procurement

- The "All in one Box" concept streamlines the procurement process by providing all necessary components in a single package.
- This can save time and effort in sourcing individual parts from multiple suppliers.



#### Engineered Packaging

- Junction Box, supports with all accessories are in one box/ pallet reducing the site material handling, shortage and effectively reducing the idle man-hours at a construction site
- Area Wise Packing reduces the material handling at site
- Integrated supply chain to support site construction schedule



#### Reduced Construction Time, Site Fabrication

- With pre-fabricated modular components, on-site construction time reduced.
- Workers can quickly assemble the rack system using standardized components.
- Minimizing installation time and labour costs.
- Minimizing the risk of material shortages at the site and ensuring a smoother installation process
- The lightweight and modular design of the components means that no crane or heavy lifting equipment is required for installation



#### Enhanced Safety

- Reducing the risk of accidents associated with hot work and fabrication activities,
- Effectively reduce Lost Time Injury (LTI)



#### Improved Quality Assurance

Standardization of components within the "ModRack" system may contribute to improved quality control, as each component undergoes rigorous testing and meets specified standards before being packaged and delivered.

- Produced in ISO 9001 facility.
- Raw material procurement as per end user specification and approved Vendor List (AVL)
- Hot dip galvanizing, painting, and coating as per Instrupack standards or as per end user specification

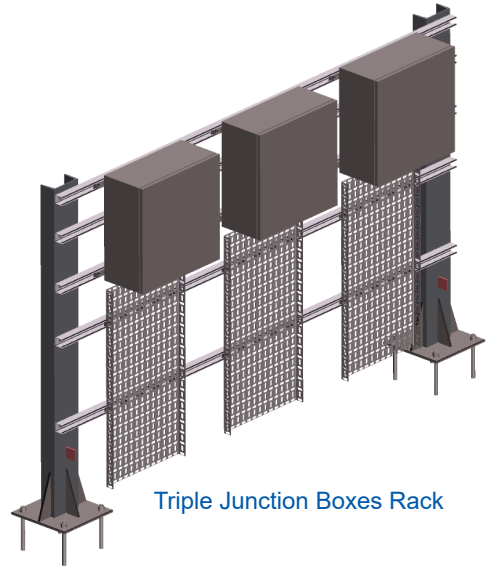

Triple Junction Boxes Rack

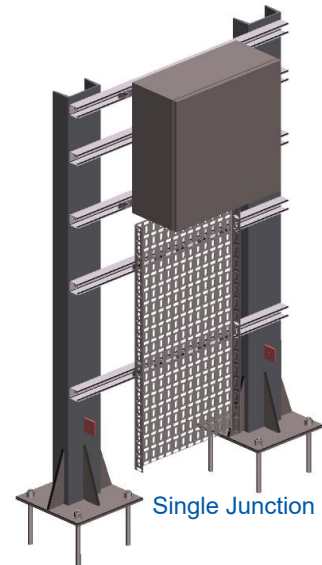

Single Junction Boxes Rack

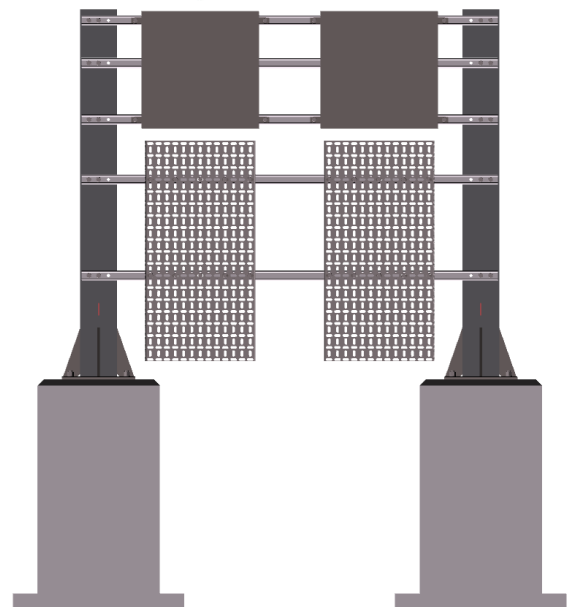

"All in one Box" package from InstruPack typically includes following items:

### Junction Boxes

Junction boxes designed to be mounted on the support rack. The junction boxes are supplied as per end-user specifications and from client approved vendor list.

### Modular Support Rack Components

Includes the main structural elements of the rack system, such as vertical Channel/Beam supports, horizontal Unistrut supports, frames, brackets and other supporting structures. These components are designed to be easily assembled and configured according to the specific requirements of the project.

### Mounting Hardware

Necessary mounting hardware, such as bolts, nuts, washers, anchor fasteners included in the package to secure the junction boxes to the support rack and to ensure the stability and integrity of the overall installation.

### Cable Management Accessories

Cable management accessories such as cable trays, are provided to help organize and route cables and wires neatly within the rack system, minimizing the risk of tangling or damage.

### Documentation and Instructions Manual

The package will include detailed documentation and instructions for the assembly, installation of the junction box racks. This information help to ensure the installation process proceeds smoothly, and the Rack is properly configured in optimal time frame.

### Optional Accessories

Depending on the specific requirements of the project, the "All in one Box" package may also include optional accessories such as grounding kits, surge protectors, labelling materials etc. to enhance the functionality and safety of the installation.

- Anchor Fasteners,
- Sunshades,
- U clamps,
- Nuts / bolts, Equipment Tag plates.
- Earthing cords, Grating clamps,
- Beam Mount Bracket

For applications requiring extra durability or load-bearing capacity, a heavy-duty version of the rack system is available, ensuring suitability for a wide range of industrial environments.

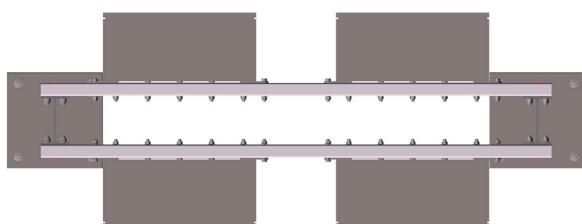

Top view Quadruple Junction Boxes

### All in one Box



Junction Boxes

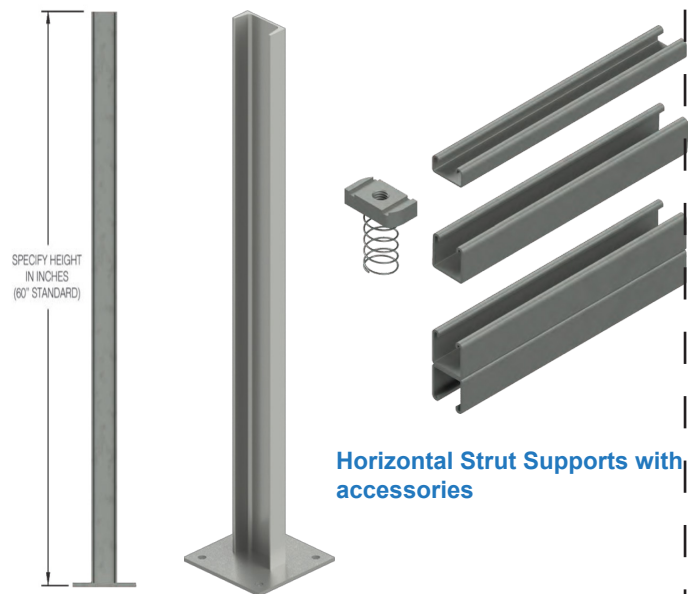

SPECIFY HEIGHT  
IN INCHES  
(60" STANDARD)

Vertical Supports

Horizontal Strut Supports with accessories

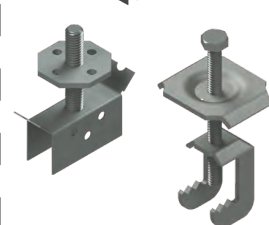
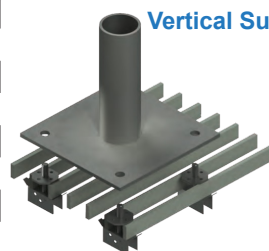

Grating Clamps



Anchor Fasteners



Nut - Bolts, Washers



Earth Cords